

CombBind C800Pro

- Ⓒ *Instruction Manual*
- Ⓕ *Manuel d'utilisation*
- Ⓓ *Bedienungsanleitung*
- Ⓘ *Manuale d'istruzioni*
- Ⓝ *Gebruiksaanwijzing*
- Ⓔ *Manual de instrucciones*
- Ⓟ *Manual de Instruções*
- Ⓣ *Kullanım Kılavuzu*
- Ⓖ *Οδηγίες*
- Ⓓ *Brugsvejledning*
- Ⓕ *Käyttöopas*
- Ⓝ *Bruksanvisning*
- Ⓢ *Bruksanvisning*
- Ⓟ *Instrukcja obsługi*
- Ⓒ *Návod k obsluze*
- Ⓕ *Használati útmutató*
- Ⓒ *Руководство по эксплуатации*



ATTENTION

To register and activate
the warranty go to
www.accoeurope.com

English	4
Français	5
Deutsch	6
Italiano	7
Nederlands	8
Español	9
Português	10
Türkçe	11
Ελληνικά	12
Dansk	13
Suomi	14
Norsk	15
Svenska	16
Polski	17
Česky	18
Magyar	19
Русский	20

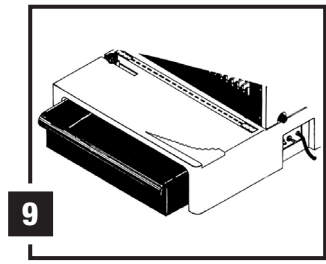
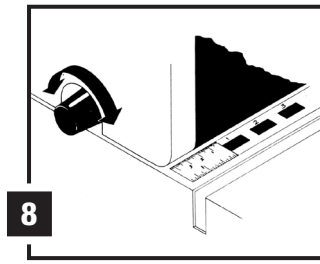
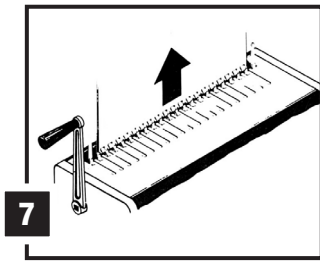
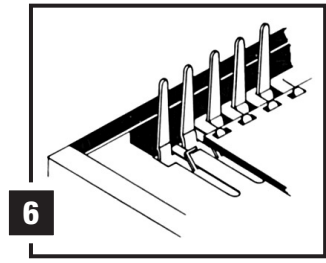
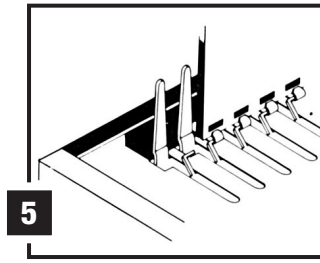
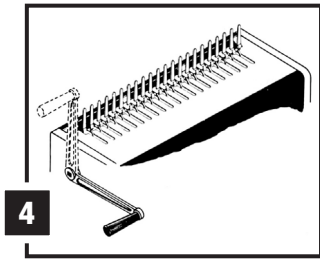
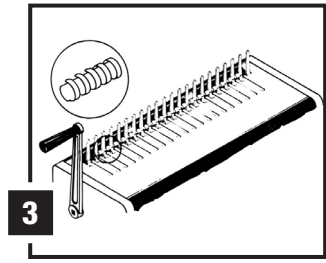
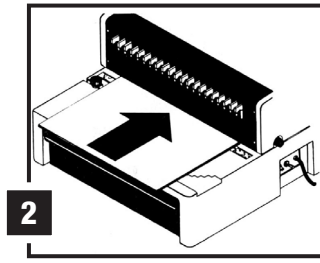
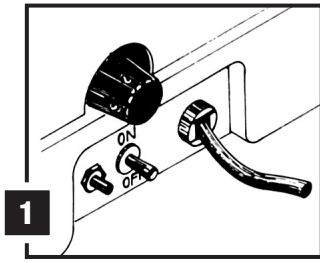
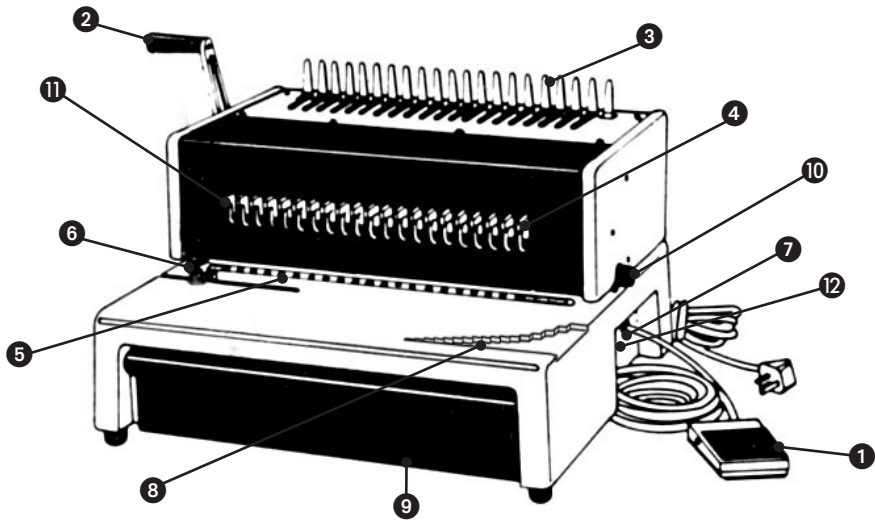

Specifications

	GBC CombBind C800Pro
Operation Mode	Electric
Max. Punch Capacity per lift (80 gsm)	20
Max Punch Capacity Foils/PVC Covers	2 x (0.2mm)
Max. Approx. Binding Capacity (80 gsm)	450
Paper Formats	A4, A5, US Letter,
Max Binding Element Cap	51mm
De-Selector Pins	Full 21 disengageable
Comb Size Selector	✓
Margin Depth Selector	✓
Machine Dimensions mm (HxWxD mm)	420 x 385 x 295
Weight	22.5kg
Voltage	230V 50 Hz AC

Setting up

- 1 Attach the handle to the machine on the left side and push in firmly to secure.
- 2 Turn the power switch on (Located on right side of machine.) Allow 30 seconds for motor to reach full speed. In cold weather, allow machine to reach room temperature before turning power on (fig. 1).
- 3 Machine reset button: If the machine should require resetting, please wait 1 min before pushing the reset button

Punching

- 1 Put sheets flush into the machine (use the side guide to adjust the position of the document before punching) (fig. 2).
- 2 Step on the foot pedal to punch

Note: The black knob on the right side of the machine is used to select the margin depth. This feature is ideal for thicker documents that require wider margins for easy page turning and more secure binding.

Maintenance

Always remember to regularly empty the drawer of clippings (fig. 9).

Guarantee

Operation of this machine is guaranteed for two years from date of purchase, subject to normal use. Within the guarantee period, Acco Brands Europe will at its own discretion either repair or replace the defective machine free of charge. Defects due to misuse or use for inappropriate purposes are not covered under the guarantee. Proof of date of purchase will be required. Repairs or alterations made by

Register this product online at www.accoeurope.com

Location of controls

- 1 Punching Pedal
- 2 Comb Opening Handle
- 3 Comb Opening Teeth
- 4 De-selectable punching pins
- 5 Punching Slot
- 6 Paper Edge Guide
- 7 On/Off Switch
- 8 Comb Size Selector
- 9 Clippings Drawer
- 10 Margin Adjuster
- 11 Comb Lock
- 12 Machine re-set button

Binding

- 1 Place binding element, open side up, behind metal fingers (fig. 3).
- 2 Pull handle forward to open rings (fig. 4).
- 3 Insert paper vertically, front cover facing you (fig. 5).
- 4 Lay down paper horizontally (fig. 6).
- 5 Return handle to upright position to close rings.
- 6 Lift vertically to remove bound document (fig. 7).

Note: The black knob on the left hand side of the machine can be set to lock in comb opening settings. The handle stops automatically at the same position each time for quicker operation during long binding runs. Simply turn the knob clockwise to open, pull handle to desired opening, then turn the knob counter-clockwise to lock (fig. 8).

Custom Binding

CombBind C800Pro has 21 de-selectable punching pins which make it possible to punch virtually any length document. Simply select or deselect the pins to adjust the punching pattern as required.

persons not authorised by Acco Brands Europe will invalidate the guarantee. It is our aim to ensure that our products perform to the specifications stated. This guarantee does not affect the legal rights which consumers have under applicable national legislation governing the sale of goods.