

**GBC**<sup>®</sup>

**ACADEMY +**  
A3 LAMINATOR

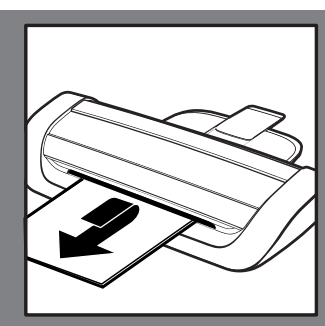

start here

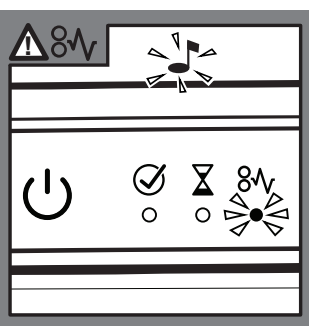
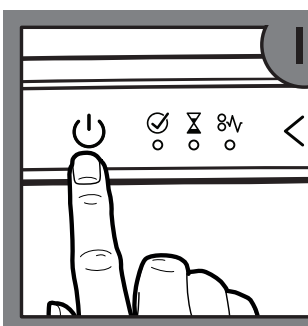
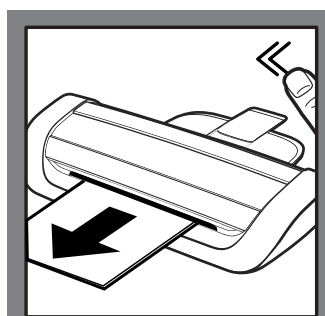
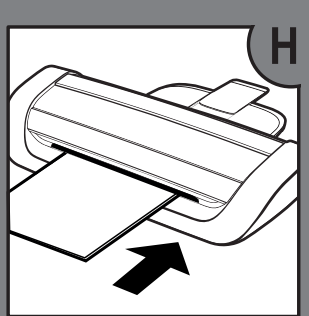
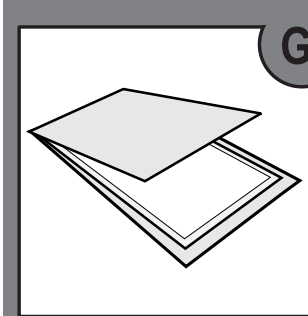
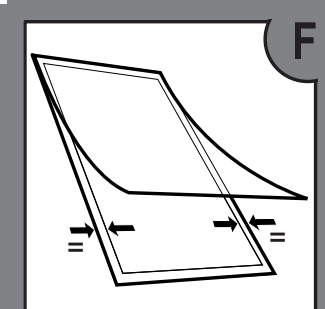
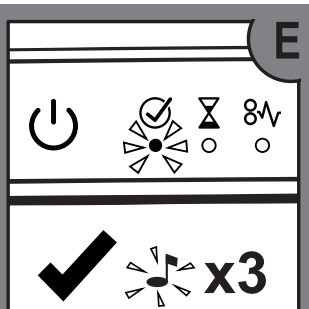
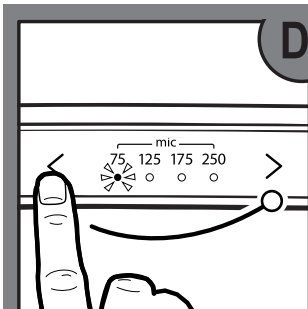
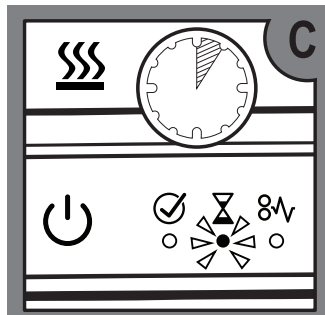
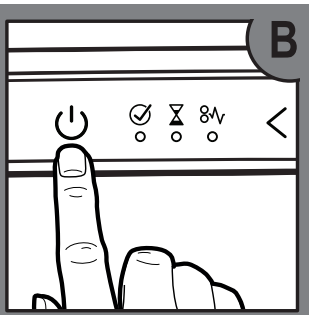

## Please read and keep these important safety instructions

- Only use the unit for its intended purpose.
- Do not touch the heating plate of this unit as it may be hot.
- The unit must only be connected to a supply voltage corresponding to the electrical rating shown on the unit.
- Unit should be connected to a socket outlet near the equipment that is easily accessible.
- Do not connect to multi adaptors or use with an extension cable.
- Failure to follow these instructions could result in damage/injury and will invalidate your guarantee.
- Do not attempt to service or repair the unit yourself.
- In the event of a fault, unplug the unit and contact an authorised GBC service representative for any required repairs.
- Do not use this unit if the cable or plug have been damaged.
- Equipment must be earthed. Only use the power cord supplied with this equipment.
- Rating label is on the base of the machine.

**THIS MACHINE MUST BE USED WITH A CARRIER.**  
A carrier is included with the machine. The carrier is a folded piece of siliconised board stitched along one end. A carrier protects the laminate as it goes through the machine for best quality results.

It is important to always use a carrier with this machine. Not using a carrier will result in the laminator becoming jammed or failing to run. This is an operator fault and is not covered by a manufacturer's warranty.

Your Academy+ laminator comes complete with one A3 and one A4 carrier.

Replacement A3 carriers or A4 size carriers can be ordered using the following item reference numbers:

Size	Quantity	Ref. Number
A3	5 Carriers	EK03000
A4	5 Carriers	EK04000

## Service

For details of your local service representative, see back page.

Products marked with this symbol meet all applicable Community regulations for the European Economic Area.

Only use the laminator in indoor areas.

The laminator complies with protection class II: The laminator is equipped with dual protective insulation and therefore contains no touchable metallic parts, which could conduct voltage in the event of a fault.

## Waste Electrical and Electronic Equipment (WEEE)

At the end of its useful life, your product is considered to be WEEE. As such, it is important to note that: WEEE is not to be disposed of as unsorted municipal waste. It is to be collected separately such that it can be disassembled so its components and materials can be recycled, re-used, and recovered (burned for energy content in the production of electricity).

Public collection points have been set up by municipalities for the collection of WEEE, free of charge to you.

Please return your WEEE to the collection facility nearest your home or office.

If you have difficulty locating a collection facility, the retailer that sold you the product should accept your WEEE.

If you are no longer in contact with your retailer, please contact ACCO for assistance with this matter.

Recycling of WEEE is geared toward protecting the environment, protecting human health, preserving raw materials, improving sustainable development, and ensuring a better supply of commodities in the European Union. This will be achieved by retrieving valuable secondary raw materials and reducing the disposal of waste. You can contribute to the success of these goals by returning your WEEE to a collection facility.

Your product is marked with the WEEE symbol (wheelie bin with an X through it). This symbol is to inform you that the WEEE is not to be disposed of as unsorted municipal waste.

## Guarantee

Operation of this machine is guaranteed for three years from date of purchase, subject to normal use. Within the guarantee period, ACCO Brands Europe will at its own discretion either repair or replace the defective machine free of charge. Defects due to misuse or use for inappropriate purposes are not covered under the guarantee. Proof of date of purchase will be required. Repairs or alterations made by persons not authorised by ACCO Brands Europe will invalidate the guarantee. It is our aim to ensure that our products perform to the specifications stated. This guarantee does not affect the legal rights which consumers have under applicable national legislation governing the sale of goods.

