

ReXel®

Instruction Manual

Momentum X312
Momentum X410



start here
starten sie hier
d marrez ici
iniziare qui
empieza aqui
comece aqui
begin hier
start her

start her
b rja h r
aloita t st 
alusta siit
s c  eit
prad ti  ia
rozprocznij tutaj
pochinaj tut

начинать здесъ
мўнда бастаңыз
za n te zde
tu za nite
kezd s itt
 ncepe aici
 keinv ste ed 
buradan ba layın



Specifications

Model	X312	X410
Cut level	P-3 (5x42mm)	P-4 (4x28mm)
Sheet Capacity	12 sheets (80 gsm)	10 sheets (80 gsm)
Duty Cycle	3 mins on / 60 mins off	3 mins on / 60 mins off
Bin Size	23 litres	23 litres
Volts / Hz	220-240V / 50/60Hz	220-240V / 50/60Hz
Amperage	0.8 A	0.8 A

Momentum X312 Momentum X410

- EN 4
- DE 6
- FR 8
- IT 10
- ES 12
- PT 14
- NL 16
- DA 18
- NO 20
- SV 22
- FI 24
- ET 26
- LV 28
- LT 30
- PL 32
- UK 34
- RU 36
- KK 38
- CS 40
- SK 42
- HU 44
- RO 46
- GR 48
- TR 50



To register and activate the warranty go to www.rexeleurope.com/register



For service addresses, go to www.rexeleurope.com

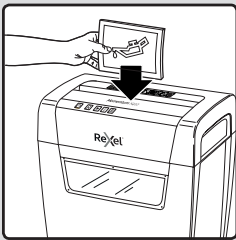
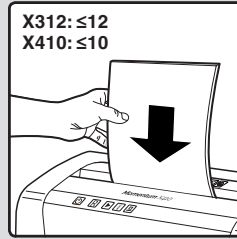
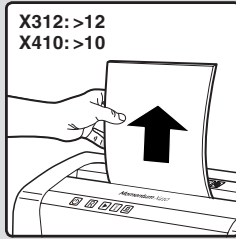
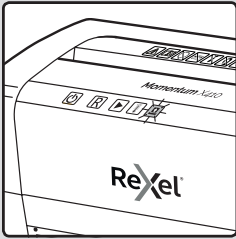
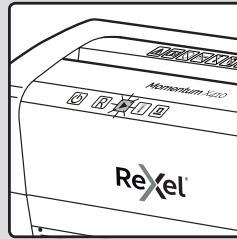
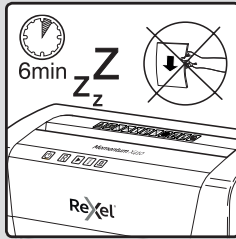
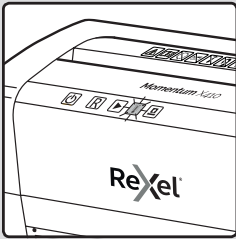
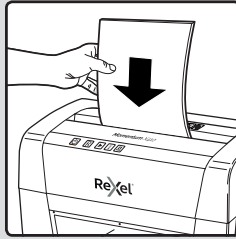
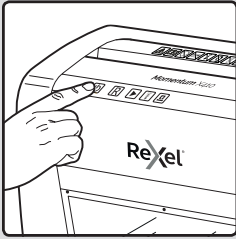
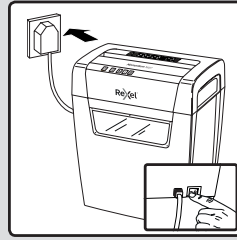
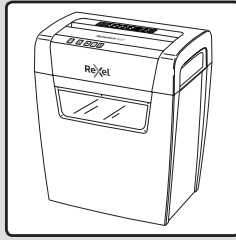
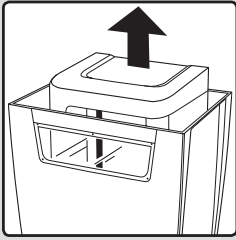



Please read and keep these important safety instructions



For a full copy of the operating instructions, hints & tips and troubleshooting guide, please visit www.rexeurope.com/support



The following symbol which is found on the product indicates you could be seriously hurt or killed if you open the machine.
DO NOT OPEN.

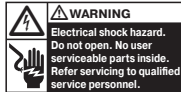

- Only use the unit for its intended purpose.
- The unit must only be connected to a supply voltage corresponding to the electrical rating shown on the unit.
- Unit should be connected to a socket outlet near the equipment that is easily accessible.
- Do not connect multiple adaptors or use with an extension cable.
- Failure to follow these instructions could result in damage/injury and will invalidate your guarantee.
- Do not attempt to service or repair the unit yourself.
- If recycling, separate paper and credit card shreds.
- Do not use this unit if the cable or plug have been damaged.
- Care should be taken when moving equipment to avoid any unlevelled surfaces.
- Please read all the safety information and the instructions. The manufacturer is not liable for cases of material damage or personal injury caused by incorrect handling or non compliance with the safety instructions. In such cases, the warranty will be voided.
- The device is intended for use indoors. Never use outdoors.
- Keep the device away from moisture.
- Be vigilant at all times, and always be careful what you are doing. Do not use electrical equipment if you are lacking in concentration or awareness, or are under the influence of drugs, alcohol or medication. Even a moment of inattentiveness can lead to serious and injuries when using electrical equipment. accidents
- Do not attempt to open, modify or repair the device. Do not drop, puncture, break or expose to high pressure.
- Alterations to the device and technical modifications are not permitted.
- Check the device and cable (and if applicable, the adapter) for any damage before use. If there is any visible damage, a strong odour, or excessive overheating of components, unplug all the components immediately and stop using the device.

Warning symbols



No CDs



Keep loose jewellery clear



No credit cards



Ties and loose clothing hazard



Keep long hair clear



Do not reach into opening



This equipment is not intended for use by children



Manual feed slot capacity

Indicators



Shredder is operating



Cooling down



Paper jam

Controls



Power on



In reverse mode

Accessories

Only use Rexel accessories:

Oil Sheets (20) - 2101949

Oil Sheets (12) - 2101948

Guarantee

Operation of this machine is guaranteed for two years within the date of purchase, subject to normal use. Within the guarantee period, ACCO Brands Europe will at its own discretion either repair or replace the defective machine free of charge. Defects due to misuse or use for inappropriate purposes are not covered under the guarantee.

Proof of date of purchase will be required. Repairs or alterations made by persons not authorised by ACCO Brands Europe will invalidate the guarantee. It is our aim to ensure that our products perform to the specifications stated. This guarantee does not affect the legal rights which consumers have under applicable national legislation governing sale of goods.

This guarantee does not apply to Australian customers - see warranty on page 52.

Momentum X312 & X410 shredding capability

CAN shred the following:



- **X312: 12 sheets**
X410: 10 sheets
- Stapled paper, 25mm within the corner
- 26/6 and 24/6 or smaller staples
- Small sized paper



- **X312: 12 sheets**
X410: 10 sheets
- Paperclipped paper, 25mm within the corner
- Capable of shredding small/medium paperclips (max. wire thickness = 0.9 mm)
- >80/100gsm paper



Thick paper or card
<200gsm



Glossy paper or a sheet covered with print on both sides.



Multiple folded sheets (A3 sheets folded in half).

CANNOT shred the following:



Heavy duty staples. Check the staple leg length is not greater than 6mm.



Large clips. Check the length of the paperclip is not longer than 32mm.



Plastic sheets, laminated documents, plastic folders.



Bulldog clips



Bound documents



Credit cards



Adhesive labels.



Magazines or other documents bound by multiple staples or clips.



No aerosols



No oil



CDs & DVDs

Waste Electrical and Electronic Equipment (WEEE)

At the end of its useful life, your product is considered to be WEEE. As such it is important to note that WEEE is not to be disposed of as an unsorted municipal waste. It is to be collected separately such that it can be disassembled so its components and materials can be recycled, re-used, and recovered (burned for energy content in the production of electricity)

Public collection points have been set up by municipalities for the collection of WEEE, free of charge to you.

Please return your WEEE to the collection facility nearest your home or office.

If you have difficulty in locating a collection facility, the retailer that sold you the product should accept your WEEE.

If you are no longer in contact with the retailer, please contact ACCO for assistance with this matter

Recycling of WEEE is geared toward protecting the environment, protecting human health, preserving raw materials. Improving sustainable development, and ensuring a better supply of commodities within the European Union. This will be achieved by retrieving valuable secondary raw materials and reducing the disposal of waste. You can contribute to the success of these goals by returning your WEEE to a collection facility.

Your product is marked with the WEEE symbol (wheelie bin with an X through it). This symbol is to inform you that the WEEE is not to be disposed off as unsorted municipal waste.