



Instruction Manual

**Momentum+
Momentum Extra+**



start here
starten sie hier
d marrez ici
iniziare qui
empieza aqu 
comece aqui
begin hier
start her

start her
b rja h r
aloita t st 
alusta siit
s c  eit
prad ti  ia
rozprocnij tutaj
pochinaj tut

начинать здесь
мۇندا бастаңыз
za n te zde
tu za nite
kezd s itt
 ncepe aici
 εκιν στε εδ 
buradan ba layın
أبد  هنا



Momentum+ Momentum Extra+

Specifications

Model	Cut size	Sheets A4 @ 80gsm	Entry width	Bin size litres	Amperage
Momentum P420+	P4	20	230	30	
Momentum P515+	P5	15			
Momentum Extra XP418+	P4	18		45	
Momentum Extra XP512+	P5	12			
Momentum Extra XP420+	P4	20		60	
Momentum Extra XP514+	P5	14			
Momentum Extra XP422+	P4	22		85	
Momentum Extra XP516+	P5	16			
Momentum Extra XP426+	P4	A4=26 / A3=19	310	120	
Momentum Extra XP520+	P5	A4=20 / A3=13			

EN	4
DE	8
FR	12
IT	16
ES	20
PT	24
NL	28
DA	32
NO	36
SV	40
FI	44
ET	48
LV	52
LT	56
PL	60
UK	64
RU	68
KK	72
CS	76
SK	80
HU	84
RO	88
GR	92
TR	96
AR	100

220-240V AC / 50Hz



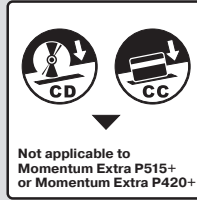
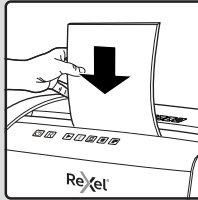
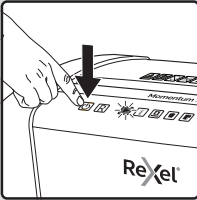
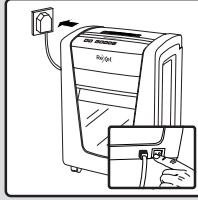
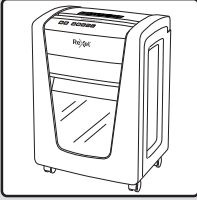

Not applicable to
Momentum Extra P515+
or Momentum Extra P420+

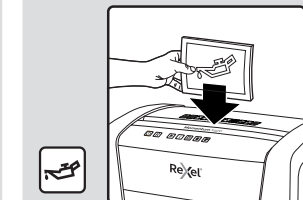
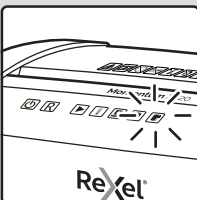
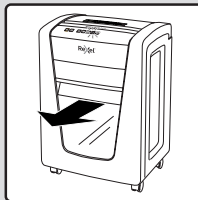
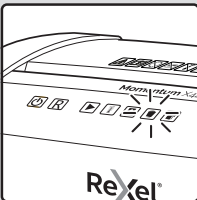
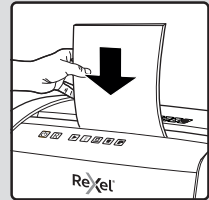
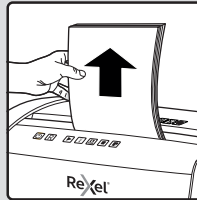
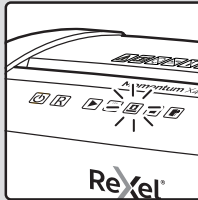
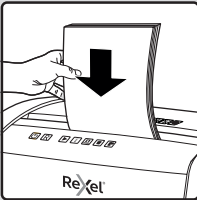
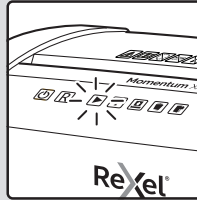
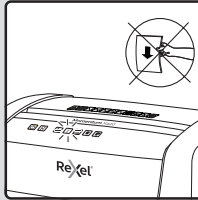
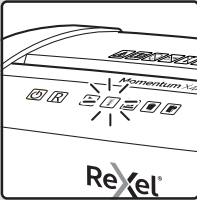



Please read and keep these important safety instructions



For a full copy of the operating instructions, hints & tips and troubleshooting guide, please visit www.rexeleurope.com/support



The following symbol which is found on the product indicates you could be seriously hurt or killed if you open the machine. **DO NOT OPEN.**

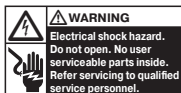

Warning: Do not touch cutters, beware of sharp edges.



Warning: Moving parts hazard, keep hands away.

- Please read all the safety information and the instructions; the manufacturer is not liable for cases of material damage or personal injury caused by incorrect handling or non-compliance with the safety instructions. In such cases, the warranty will be voided.
- Only use the unit for its intended purpose.
- The unit must only be connected to a supply voltage corresponding to the electrical rating shown on the unit.
- Unit should be connected to a socket outlet near the equipment that is easily accessible.
- Do not connect multiple adaptors or use with an extension cable.
- Do not attempt to service or repair the unit yourself.
- If recycling, separate paper and credit card shreds.
- Do not use this unit if the cable or plug have been damaged.
- Care should be taken when moving equipment to avoid any unlevelled surfaces.
- The device is intended for use indoors. Never use outdoors.
- Keep the device away from moisture.
- Be vigilant at all times, and always be careful what you are doing. Do not use electrical equipment if you are lacking in concentration or awareness, or are under the influence of drugs, alcohol or medication. Even a moment of inattentiveness can lead to serious injuries when using electrical equipment.
- Do not attempt to open, modify or repair the device. Do not drop, puncture, break or expose to high pressure.
- Alterations to the device and technical modifications are not permitted.
- Check the device and cable (and if applicable, the adapter) for any damage before use. If there is any visible damage, a strong odour, or excessive overheating of components, unplug all the components immediately and stop using the device.
- Shredder must be disconnected from power source if not used for an extended period of time.
- Do not use spray cleaners or spray lubricants as these may present a risk of flash fire.
- Never bypass the safety interlock (strictly forbidden and dangerous, especially when unit is connected to a power source).
- Do not lean on the shredder door; this may damage the door and will not be covered by your warranty.
- Failure to follow these instructions could result in damage/injury and will invalidate your guarantee.

Warning symbols



Warning symbols



Keep loose jewellery clear



This means do not shred Credit Cards



Ties and loose clothing hazard



Keep long hair clear



Do not reach into opening



This equipment is not intended for use by children



No aerosols. Do not use spray cleaners or lubricants, as these may present a risk of flash fire.



Max sheet capacity



Warning: do not shred CD in paper feed slot



No heavy duty staples above 26mm



Warning: moving parts











Warning: This equipment is not intended for use by children. Avoid touching the media feed opening with the hands, clothing or hair. Unplug this equipment when not in use for an extended period of time. Hazardous moving parts are in this equipment; keep body parts away from moving parts.





Warning: The power cord must be connected to a socket-outlet with earthing connection.



Only shred CDs and credit cards in the separate slot, as indicated.

Icon	Type	Button / indication & action (troubleshoot)
	Control buttons	Auto-start and stand-by button (press one time)
		Manual reverse button (hold down)
		Manual forward run button (hold down)
	Status indications	Ready indicator, ready to shred and no overload
		Over heating indication (Allow to cool)
		Overloaded / Jam indication (Reduce sheets / remove jammed paper)
		Bin full indication (open door and empty the bin)
		Door open or shredder head removed indication (close door firmly)

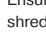
Operation

- Remove the shredder from the packaging and place the bin inside the shredder housing. Plug the power cord into the rear of the shredder.
- Connect the shredder to an appropriate mains supply.
Ensure the on/off switch is in the 'on' position. The blue shredder in operation icon  will flash every 3 seconds.
- To commence shredding press the  button. The flashing icon  changes to a solid blue light. You are now able to shred.
- Insert paper to be shredded into the feed area. The Anti-Jam Mechanism will sense the thickness of the paper being shredded.

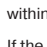
If the paper stack thickness is greater than the shredder's sheet capacity, the Anti-Jam indicator will turn on. Please remove the stack of paper and reduce the number of sheets to within the specified capacity .

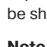
If the paper stack thickness is within the specified sheet capacity, the blue Ready triangle will remain on and paper will be shredded .

Note: Make sure the paper to be inserted is neatly stacked.

If the paper thickness is within the shredder's capacity, the motor will start and your documents will be shredded. The cutters will stop once the shredding process is complete.

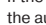
- If the paper thickness is greater than the shredder's capacity the auto reverse icon will flash red  and the motor will stop.

- If this happens, remove some of the sheets from the paper stack and re-try. The shredder will automatically start and allow the paper to be shredded.
- If the shredder is left in shredder operational mode for more than 30 minutes without being used the shredder will automatically switch off in order to save power.



Warning: Do NOT under any circumstances use any metal objects (scissors, letter openers, etc.) in an attempt to clear the entry.

Anti-Jam Technology

This shredder will only shred stacks of paper within the specified sheet capacity; if there are too many sheets, the stack of paper will be rejected and the shredder will not start.

During the shredding process do not attempt to add more paper as this will cause a paper overload and auto-reverse will start; paper will then need to be removed.

Reverse function

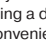
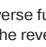
- Should you wish to reverse the shredding direction whilst shredding a document a reverse function  has been fitted for your convenience.
- By pressing the reverse button the cutters will change direction allowing the retrieval of the document being shredded.
- The reverse function will only run whilst  is being pressed. When the reverse button is released the shredder will revert to ready mode.

Operation time

When the shredder is used continuously, the shredder may overheat. If this occurs the overheat icon  will illuminate red.

When the shredder is ready to be used again the red overheat icon will go out.

To resume shredding, press the On button and start feeding documents into the feed slot.



Only shred CDs and credit cards in the separate slot, as indicated.

Momentum+ & Momentum Extra+ shredding capability

CAN shred the following:



- Stapled paper, 25mm within the corner
- 26/6 and 24/6 or smaller staples
- Small sized paper



- Paperclipped paper, 25mm within the corner
- Capable of shredding small/medium paperclips (max. wire thickness = 0.9 mm)
- >80/100gsm paper



Thick paper or card
<200gsm



Glossy paper or a sheet covered with print on both sides.



Warning! Only shred CD in machines with a separate CD shredding slot.

CANNOT shred the following:



Heavy duty staples. Check the staple leg length is not greater than 6mm.



Large clips. Check the length of the paperclip is not longer than 32mm.



Plastic sheets, laminated documents, plastic folders.



Bulldog clips



Bound documents



Adhesive labels.



Magazines or other documents bound by multiple staples or clips.



No aerosols



No oil



Warning! Never shred CDs in the paper feed slot.

Bin full

When the bin is full the shredder will not function and the bin full symbol will illuminate and flash red.

When this happens you must empty the bin.

Pull out the bin to empty.

Once the bin is empty, push it back in and press the On button to resume shredding.



WARNING: The shredder bin must be fully pushed closed for the machine to operate.

- Empty the shredder bin when it is full otherwise the shredder's performance will be adversely affected. Operating the shredder with a full shredder bin can result in paper jamming in the cutters, which will increase the machine's noise level.
- Do not force down shredder paper in the bin using your feet.

Door open

If the door is opened during shredding as a safety precaution the shredder will instantly stop, and the door open symbol on the indicator panel will flash red.

To resume shredding, shut the door and press the button.



WARNING

- The shredder DOOR must be fully pushed closed for the machine to operate.

Lubrication of the shredder

Only use Rexel Oil Sheets (2101948 / 2101949) to lubricate. ACCO Brands accepts no liability for product performance or safety when other types of lubricants are used on any part(s) of this machine. Rexel recommend using an oil sheet after the bin has been emptied three times (and every three bin emptying after this).

Accessories

Only use Rexel accessories:
Oil Sheets – 2101948 / 2101949



Waste Electrical and Electronic Equipment (WEEE)

Electrical and electronic devices contain materials and substances that can have damaging effects on human health and the environment. This symbol indicates that this device must not be treated as unsorted municipal waste but must be collected separately. Dispose of the device via a collection point for the recycling of waste electrical and electronic equipment within the EU, UK and in other European countries that operate separate collection systems for waste electrical and electronic equipment. By disposing of the device in the proper manner, you help to avoid possible hazards for the environment and public health that could otherwise be caused by improper treatment of waste equipment. The recycling of materials contributes to the conservation of natural resources.

Guarantee

Operation of this machine is guaranteed for two years within the date of purchase, subject to normal use. Within the guarantee period, ACCO Brands Europe will at its own discretion either repair or replace the defective machine free of charge. Defects due to misuse or use for inappropriate purposes are not covered under the guarantee.

Proof of date of purchase will be required. Repairs or alterations made by persons not authorised by ACCO Brands Europe will invalidate the guarantee. It is our aim to ensure that our products perform to the specifications stated. This guarantee does not affect the legal rights which consumers have under applicable national legislation governing sale of goods.

This guarantee does not apply to Australian customers - see end of manual.